



COMPETENCE STATEMENT
HOTEL & RESORT

CUBES ASIA CO., LTD

 **CUBES**
Coffee Competence



TABLE
OF
CONTENTS

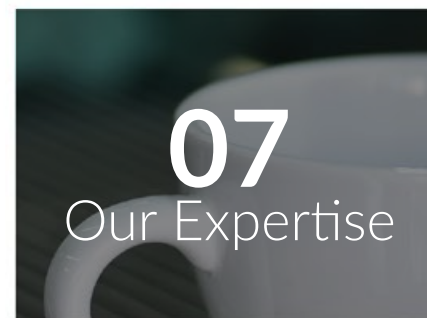
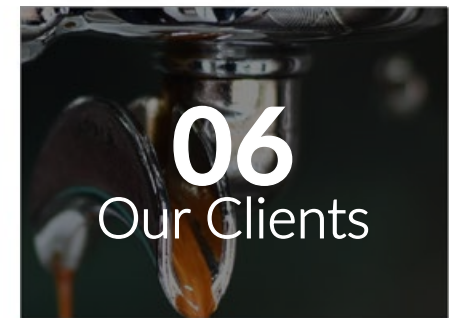
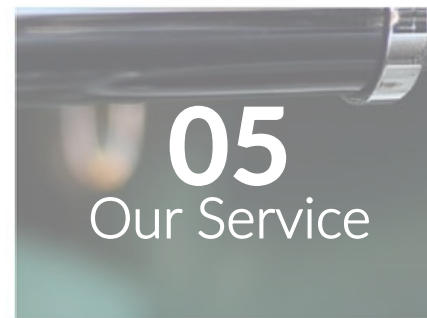
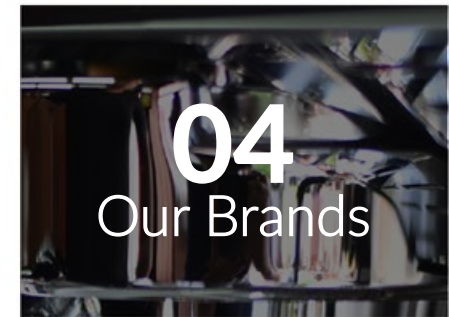
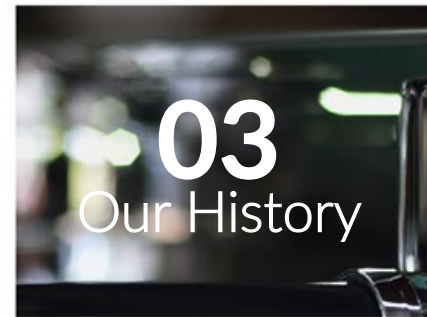



OUR HISTORY

TURNOVER GROWTH BY YEAR

Unit: Million USD

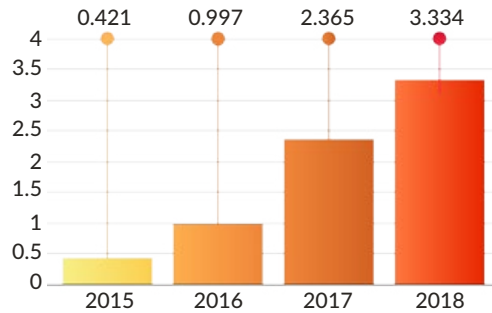

Cubes Asia is the leading coffee solution provider in Vietnam.

2012 Cubes Asia started to offer competent coffee solutions in Vietnam.

2014 As exclusive distributor of Nuova Simonelli (Italy) and Melitta (Germany) in Vietnam Cubes Asia takes the quality lead in coffee solutions.

2016 Cubes Asia opens second showroom in Saigon and a Showroom/Service Center in Danang.

2017 Through the exclusive Victoria Arduino distribution Cubes Asia becomes the leader in specialty coffee machines in Vietnam and starts the sponsorship of the VN Barista championship (VNBC). With a Showroom/Service Center in Hanoi and a trained dealer network Cubes Asia reached countrywide service coverage.

2018 Establishment of **CUBESLAB** as a competence and barista training center. With Schaerer and BWT the portfolio of premium international brands for coffee solutions is complete. Cubes Asia takes the lead position in coffee solutions for Vietnam.

2019 Cubes-Lab is certified by the SCA - World specialty coffee association - as a registered specialty coffee campus. A second Cubes-Lab is developed in Hanoi.

REPRESENTATIVE DEALER

Ha Noi

www.horecavn.com
www.meta.vn
www.kokcoffee.vn

Hue

www.greenfieldscoffee.com

Da Nang

www.mayacacoffee.com
www.danacafe.vn

Gia Lai

www.lamantcafe.vn

Dak Lak

www.azzan.vn

Sai Gon

www.phuongbinhgroup.com.vn
www.iqplus.vn
www.trungnguyen.com.vn
www.lahacoffee.vn
www.lybaominh.com



VIET NAM

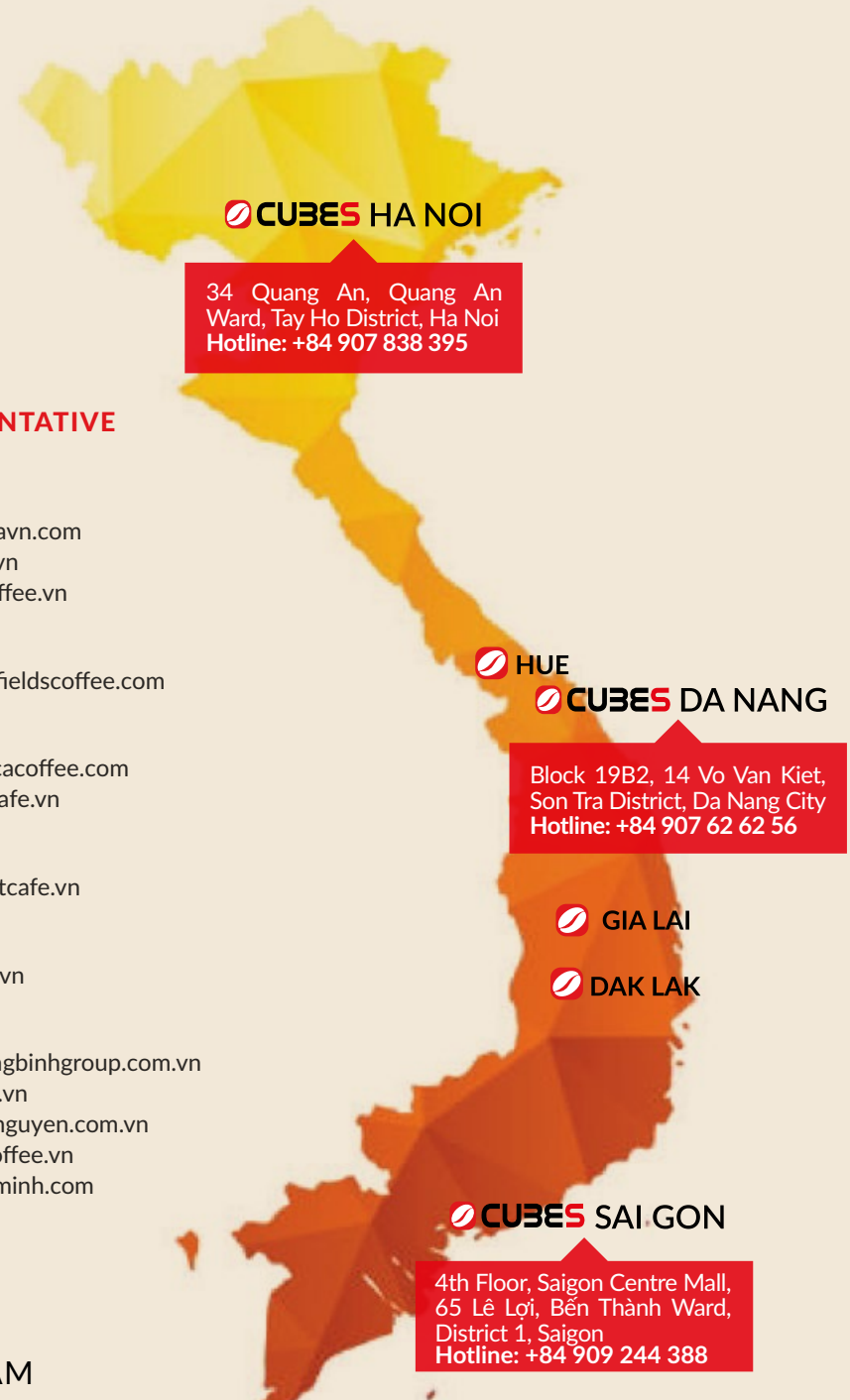

CUBES HA NOI

34 Quang An, Quang An Ward, Tay Ho District, Ha Noi
 Hotline: +84 907 838 395

HUE

CUBES DA NANG

Block 19B2, 14 Vo Van Kiet, Son Tra District, Da Nang City
 Hotline: +84 907 62 62 56

GIA LAI

DAK LAK

CUBES SAI GON

4th Floor, Saigon Centre Mall, 65 Lê Lợi, Bến Thành Ward, District 1, Saigon
 Hotline: +84 909 244 388



OUR
BRANDS

We are exclusive distributors of premium brands in the coffee industry. We can supply the right machine and equipment for each location.

OUR SERVICE

CONSULTING

Our sales team is qualified and helpful. Our staff is officially trained by experts from international brands to provide you the best solutions and coffee experience.

PRODUCTS

As exclusive distributor of leading international manufacturers, we do not compromise on quality.

INSTALLATION

Our trained technicians reliably install the even most complex machines.

TRAINING

Our home barista and the Cubes-Lab provide world class training for all machines.

MAINTENANCE - WARRANTY

With countrywide coverage of service center, we warrantee fast and reliable service.





OUR

CLIENTS

We worked with major players in this market and gained the trust of international brands namely Accor, Hyatt, Mövenpick, Interncontinental, Vinpearl, etc

HYATT

MÖVENPICK



INTERCONTINENTAL



ACCOR HOTELS

Feel Welcome



VINPEARL

Dusit

HOTELS & RESORTS

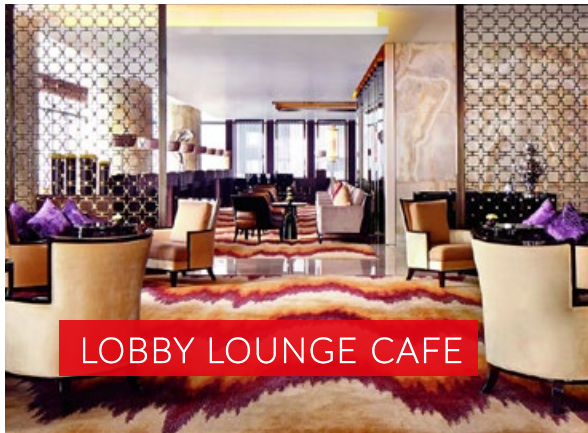

LOBBY LOUNGE CAFE

OUR EXPERTISE

Our consultants team help you to find the right solution for each location.

The continuous improvement of supporting company processes results in high customer satisfaction because we can offer the best value for money, fast delivery and good service.



RESTAURANT



ALL DAY DINING BUFFET
SELF SERVE



POOL



BALLROOM/PRE-FUNCTION



ROOM

Plan 1

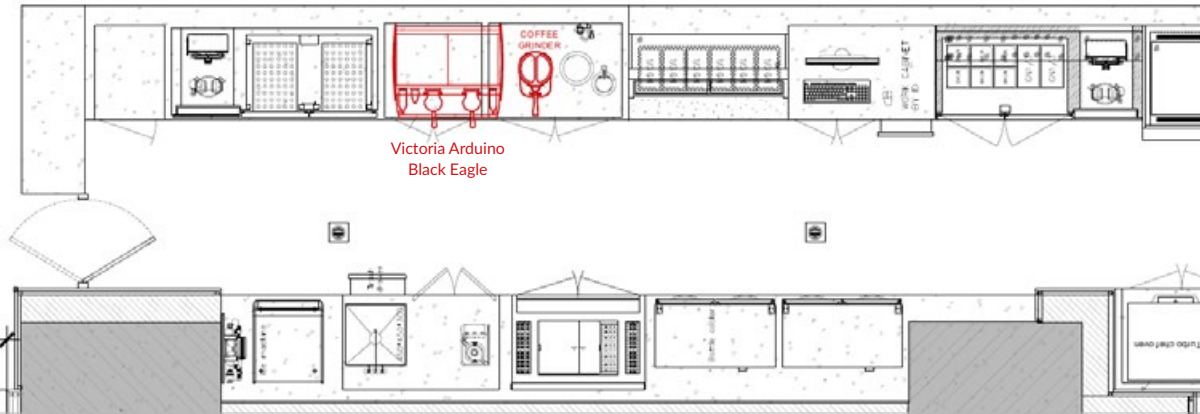

Plan 2

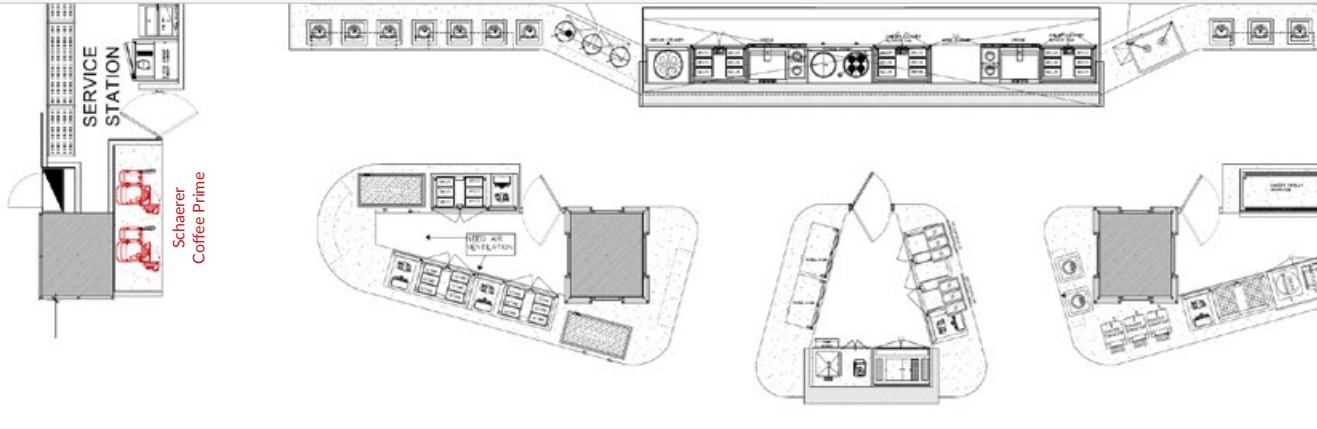

PLANNING

SUPPORT

We provide full planning support with all product supplied so everything gets exact and easier than ever.

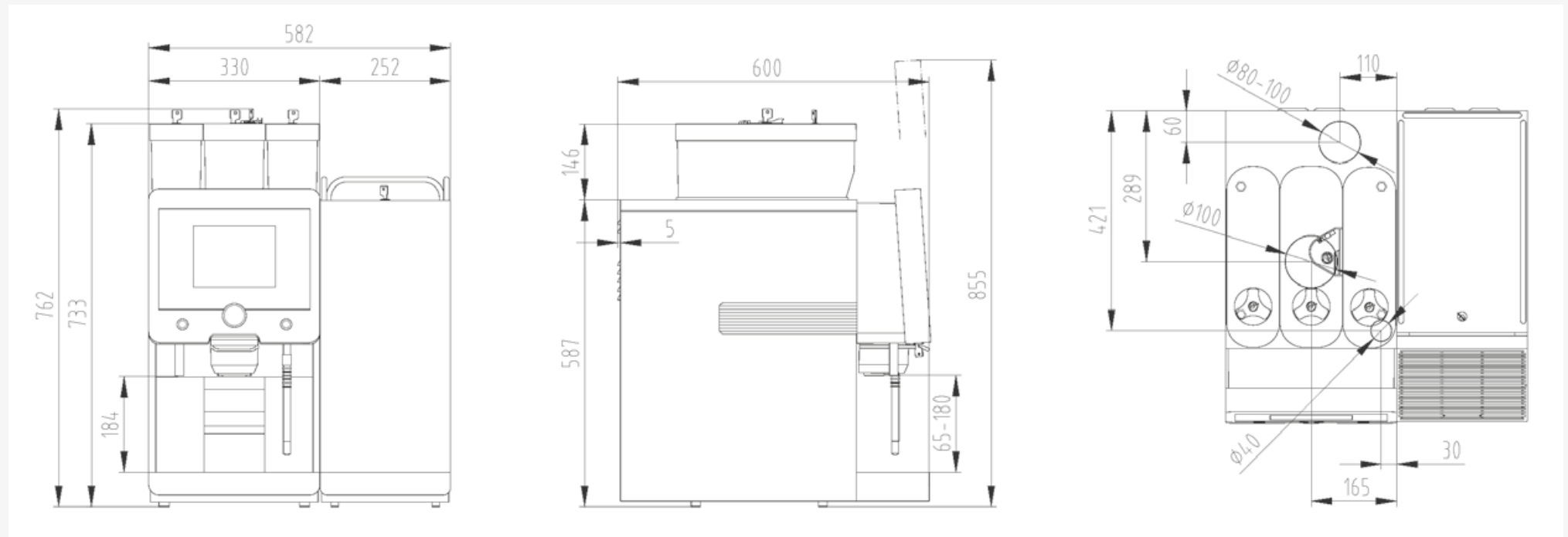

DATA

POOL

The products come with ACAD plan and Section, Technical data sheet, Sketch up file or 3D studio file which are available on our website:

<https://cubes-asia.com/vn/tai-lieu-ho-tro.html>

will support your piece of work.





COFFEE

SOLUTION

We offer efficient solutions for each location as well as a suitable training and maintenance plan. We ensure you will always be able to serve the perfect cup!





LOBBY LOUNGE CAFE

LUXURY

VICTORIA ARDUINO EAGLE ONE

- Espresso / Cappuccino
- 80 cups / hour
- 250 cups / day
- Customization
- Needs trained Barista

Victoria Arduino



MEDIUM

NUOVA SIMONELLI APPIA LIFE 2 GROUP

- Espresso / Cappuccino
- 80 cups / hour
- 250 cups / day
- Needs trained Barista

nuova
SIMONELLI



BUDGET

LELIT GIULIETTA

- Espresso / Cappuccino
- 70 cups / hour
- 200 cups / day
- Needs trained Barista

LELIT





ALL DAY DINING BUFFET SELF SERVE

LUXURY

SCHAERER COFFEE ART PLUS

- Espresso / Cappuccino
- 70 cups / hour
- 150 cups / day
- Touch screen and customization



schaerer
swiss coffee competence

MEDIUM

NUOVA SIMONELLI PRONTOBAR TOUCH

- Espresso / Cappuccino
- 50 cups / hour
- 120 cups / day
- Touch screen



nuova SIMONELLI

BUDGET

SCHAERER COFFEE PRIME

- Espresso / Cappuccino
- 70 cups / hour
- 150 cups / day
- Touch screen and customization



schaerer
swiss coffee competence



BALLROOM / PRE-FUNCTION

LUXURY

ANIMO®

ANIMO CB 10+10+2 EXTRA CONTAINERS

- Americano / Tea
- 2x240 cups / hour
- 2x80 cups / brew
- BOH with Containers for Pre-function



MEDIUM

ANIMO®

ANIMO CB 5 HW+6 EXTRA CONTAINERS

- Americano / Tea
- 180 cups / hour
- 40 cups / brew
- BOH with Containers for Pre-function



BUDGET

ANIMO®

PERCOLATOR ANIMO 12L

- Americano / Tea
- 120 cups / hour
- 96 cups / brew
- BOH with Containers for Pre-function





RESTAURANT

LUXURY

VICTORIA ARDUINO VENUS BAR 2 GROUP

- Espresso / Cappuccino
- 80 cups / hour
- 250 cups / day
- Needs trained Barista



Victoria Arduino

MEDIUM

VENUS FAMILY 1 GROUP

- Espresso / Cappuccino
- 30 cups / hour
- 100 cups / day
- Needs trained Barista



Victoria Arduino

BUDGET

APPIA LIFE 1 GROUP

- Espresso / Cappuccino
- 50 cups / hour
- 150 cups / day



nuova
SIMONELLI

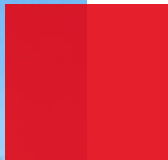

POOL

LUXURY

MELITTA BARISTA TS SMART

- Espresso / Cappuccino
- 30 cups / hour
- 60 cups / day
- Easy one-touch operation



MEDIUM

MELITTA CI TOUCH

- Espresso / Cappuccino
- 30 cups / hour
- 50 cups / day
- Easy one-touch operation



BUDGET

MELITTA SOLO AND CREMIO

- Espresso / Cappuccino
- 20 cups / hour
- 30 cups / day
- Easy operation





ROOM

LUXURY

MELITTA PASSIONE OT

- Espresso / Cappuccino
- 25 cups / hour
- 40 cups / day
- Easy operation



MEDIUM

KRUPS ESSENZA MINI

- Espresso
- 10 cups / day
- Easy operation



KRUPS

BUDGET

MELITTA POUR OVER SET

- Drip coffee
- 4 cups / brew
- Manual brewing



ENJOY

YOUR COFFEE

CUBES HEAD OFFICE

Suite 102, Kim Do Building, 123 Le Loi,
Ben Thanh Ward, District 1, Saigon,
Vietnam

Hotline : + 84 909 244 388

Tel : + 84 2838 211 833

CUBES SAI GON

4th Floor, Saigon Centre Mall
65 Le Loi, Ben Thanh Ward, District 1,
Saigon, Vietnam

Hotline : + 84 909 244 388

Tel : + 84 2838 211 833

CUBES DA NANG

Block 19B2, 14 Vo Van Kiet, Son Tra
District, Da Nang City

Hotline: + 84 907 626 256

Tel : + 84 236 355 3033

CUBES HA NOI

34 Quang An, Quang An Ward, Tay Ho
District, Ha Noi

Hotline: + 84 907 838 395

Tel : + 84 24 3837 4333

www.cubes-asia.com

